

**This electronic collection of documents is provided
for the convenience of the user
and is Not a Certified Document –**

**The documents contained herein were originally issued
and sealed by the individuals whose names and license
numbers appear on each page, on the dates appearing
with their signature on that page.**

**This file or an individual page
shall not be considered a certified document.**

STATE	STATE PROJECT REFERENCE NO.	SHEET NO.	TOTAL SHEETS
N.C.	44236	1	
TIP NO.	WBS NO.	DESCRIPTION	
	44236		

STATE OF NORTH CAROLINA
DIVISION OF HIGHWAYS

HENDERSON COUNTY

LOCATION: BEGIN AT THE INTERSECTION OF SR2069 (INDUSTRIAL DRIVE ROAD) AND SR2421 (SUMMERWIND ROAD) AND CONTINUE IN A NORTHERLY DIRECTION FOR A TOTAL OF 1,190 FEET TO END OF PROJECT.

TYPE OF WORK: PAVING, SHOULDER RECONSTRUCTION, PAVEMENT MARKING, TRAFFIC CONTROL.

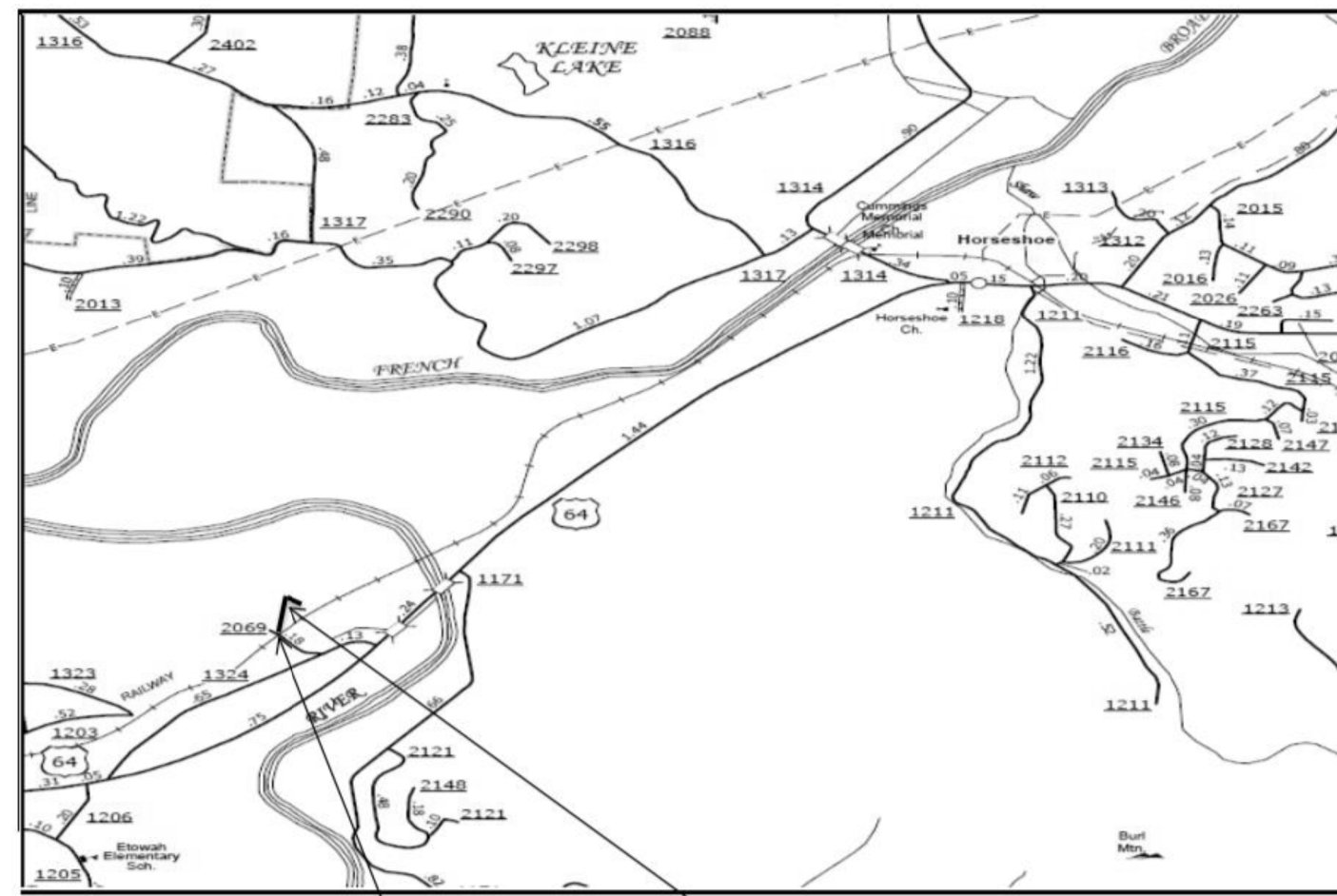

BEGIN PROJECT END PROJECT

Proposed Cul-de-sac
End of Project
Sta 11 + 90

SR 2421 SUMMERWIND
NOT TO SCALE



NOT TO SCALE

PROJECT LENGTH

SUMMERWIND ROAD - 44236 (0.23 MILES)

Prepared In the Office of:
DIVISION OF HIGHWAYS
1000 Birch Ridge Dr., Raleigh NC, 27610

2012 STANDARD SPECIFICATIONS

RIGHT OF WAY DATE:

LETTING DATE:

S.L. Cannon, PE
PROJECT ENGINEER

R.C. Chambard
PROJECT DESIGN ENGINEER

HYDRAULICS ENGINEER

SIGNATURE: _____ P.E.

ROADWAY DESIGN
ENGINEER

SIGNATURE: _____ P.E.

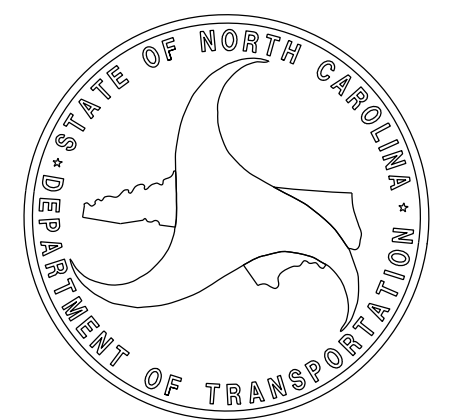

TIP PROJECT: 44236

CONTRACT: DN00382

08/21/2017

GENERAL NOTES:

ALL THE STANDARD DRAWINGS LISTED IN THIS CONTRACT, MAY OR MAY NOT BE APPLICABLE.

UTILITY OWNERS ON THIS PROJECT ARE:

MORRIS BROADBAND LLC. (828-772-1167), AT&T (1-800-778-9140), PSNC ENERGY (877-776-2427), DUKE ENERGY (800-769-3766),

ANY RELOCATION OF EXISTING UTILITIES WILL BE ACCOMPLISHED BY OTHERS.

INDEX OF SHEETS

<u>SHEET NUMBER:</u>	<u>SHEET:</u>
1	TITLE SHEET
1A	INDEX OF SHEETS
1B	CONVENTIONAL SYMBOLS
2A	PAVEMENT SCHEDULE & TYPICAL

2012 STANDARD SPECIFICATIONS FOR ROADS AND STRUCTURES **EFF. 01-17-2012**
REV. 10-30-2012

The following Roadway Specifications as appear in "Standard Specifications For Roads And Structures" Highway Design Branch - N. C. Department of Transportation - Raleigh, N. C., Dated January, 2012 are applicable to this project and by reference hereby are considered a part of these plans:

- | SPEC NO. | TITLE |
|---|---------------------------------------|
| DIVISION 5 - SUBGRADE, BASES AND SHOULDERS | |
| Section 535 | Conditioning Existing Base |
| DIVISION 6 - ASPHALT PAVEMENTS | |
| Section 610 | Asphalt Concrete Plant Mix Pavements |
| Section 620 | Asphalt Binder For Plant Mix |
| DIVISION 11 - WORK ZONE TRAFFIC CONTROL | |
| Section 1105 | Temporary Traffic Control Devices |
| DIVISION 12 - PAVEMENT MARKINGS, MARKERS AND DELINEATION | |
| Section 1205 | Pavement Marking General Requirements |

STATE OF NORTH CAROLINA, DIVISION OF HIGHWAYS

CONVENTIONAL PLAN SHEET SYMBOLS

Note: Not to Scale *S.U.E. = *Subsurface Utility Engineering*

BOUNDARIES AND PROPERTY:

State Line	-----
County Line	-----
Township Line	-----
City Line	-----
Reservation Line	-----
Property Line	-----
Existing Iron Pin	○
Computed Property Corner	-----
Property Monument	□
Parcel/Sequence Number	②
Existing Fence Line	-x-x-x-
Proposed Woven Wire Fence	○
Proposed Chain Link Fence	□
Proposed Barbed Wire Fence	◇
Existing Wetland Boundary	-----
Proposed Wetland Boundary	-----
Existing Endangered Animal Boundary	-----
Existing Endangered Plant Boundary	-----
Existing Historic Property Boundary	-----
Known Contamination Area: Soil	☠-s-☠
Potential Contamination Area: Soil	☠-s-☠
Known Contamination Area: Water	☠-w-☠
Potential Contamination Area: Water	☠-w-☠
Contaminated Site: Known or Potential	☠

BUILDINGS AND OTHER CULTURE:

Gas Pump Vent or U/G Tank Cap	○
Sign	○
Well	♀
Small Mine	⊗
Foundation	□
Area Outline	□
Cemetery	⊕
Building	□
School	□
Church	⊕
Dam	⊕

HYDROLOGY:

Stream or Body of Water	-----
Hydro, Pool or Reservoir	□
Jurisdictional Stream	-----
Buffer Zone 1	-----
Buffer Zone 2	-----
Flow Arrow	←
Disappearing Stream	-----
Spring	○
Wetland	-----
Proposed Lateral, Tail, Head Ditch	-----
False Sump	-----

RAILROADS:

Standard Gauge	-----
RR Signal Milepost	-----
Switch	□
RR Abandoned	-----
RR Dismantled	-----

RIGHT OF WAY & PROJECT CONTROL:

Secondary Horiz and Vert Control Point	◆
Primary Horiz Control Point	○
Primary Horiz and Vert Control Point	●
Exist Permanent Easment Pin and Cap	◇
New Permanent Easment Pin and Cap	◆
Vertical Benchmark	⊕
Existing Right of Way Marker	△
Existing Right of Way Line	-----
New Right of Way Line	-----
New Right of Way Line with Pin and Cap	-----
New Right of Way Line with Concrete or Granite RW Marker	-----
New Control of Access Line with Concrete CA Marker	-----
Existing Control of Access	-----
New Control of Access	-----
Existing Easement Line	-----
New Temporary Construction Easement	-----
New Temporary Drainage Easement	-----
New Permanent Drainage Easement	-----
New Permanent Drainage / Utility Easement	-----
New Permanent Utility Easement	-----
New Temporary Utility Easement	-----
New Aerial Utility Easement	-----

ROADS AND RELATED FEATURES:

Existing Edge of Pavement	-----
Existing Curb	-----
Proposed Slope Stakes Cut	-----
Proposed Slope Stakes Fill	-----
Proposed Curb Ramp	-----
Existing Metal Guardrail	-----
Proposed Guardrail	-----
Existing Cable Guiderail	-----
Proposed Cable Guiderail	-----
Equality Symbol	⊕
Pavement Removal	-----

VEGETATION:

Single Tree	○
Single Shrub	⊗

Hedge	-----
Woods Line	-----
Orchard	-----
Vineyard	-----

EXISTING STRUCTURES:

MAJOR:	
Bridge, Tunnel or Box Culvert	-----
Bridge Wing Wall, Head Wall and End Wall	-----
MINOR:	
Head and End Wall	-----
Pipe Culvert	-----
Footbridge	-----
Drainage Box: Catch Basin, DI or JB	□
Paved Ditch Gutter	-----
Storm Sewer Manhole	⊕
Storm Sewer	-----

UTILITIES:

POWER:	
Existing Power Pole	●
Proposed Power Pole	○
Existing Joint Use Pole	●
Proposed Joint Use Pole	○
Power Manhole	⊕
Power Line Tower	⊕
Power Transformer	⊕
U/G Power Cable Hand Hole	-----
H-Frame Pole	-----
U/G Power Line LOS B (S.U.E.*)	-----
U/G Power Line LOS C (S.U.E.*)	-----
U/G Power Line LOS D (S.U.E.*)	-----

TELEPHONE:

Existing Telephone Pole	●
Proposed Telephone Pole	○
Telephone Manhole	⊕
Telephone Pedestal	⊕
Telephone Cell Tower	⊕
U/G Telephone Cable Hand Hole	-----
U/G Telephone Cable LOS B (S.U.E.*)	-----
U/G Telephone Cable LOS C (S.U.E.*)	-----
U/G Telephone Cable LOS D (S.U.E.*)	-----
U/G Telephone Conduit LOS B (S.U.E.*)	-----
U/G Telephone Conduit LOS C (S.U.E.*)	-----
U/G Telephone Conduit LOS D (S.U.E.*)	-----
U/G Fiber Optics Cable LOS B (S.U.E.*)	-----
U/G Fiber Optics Cable LOS C (S.U.E.*)	-----
U/G Fiber Optics Cable LOS D (S.U.E.*)	-----

WATER:

Water Manhole	⊕
Water Meter	○
Water Valve	⊗
Water Hydrant	⊕
U/G Water Line LOS B (S.U.E.*)	-----
U/G Water Line LOS C (S.U.E.*)	-----
U/G Water Line LOS D (S.U.E.*)	-----
Above Ground Water Line	-----

TV:

TV Pedestal	⊕
TV Tower	⊗
U/G TV Cable Hand Hole	-----
U/G TV Cable LOS B (S.U.E.*)	-----
U/G TV Cable LOS C (S.U.E.*)	-----
U/G TV Cable LOS D (S.U.E.*)	-----
U/G Fiber Optic Cable LOS B (S.U.E.*)	-----
U/G Fiber Optic Cable LOS C (S.U.E.*)	-----
U/G Fiber Optic Cable LOS D (S.U.E.*)	-----

GAS:

Gas Valve	◇
Gas Meter	⊕
U/G Gas Line LOS B (S.U.E.*)	-----
U/G Gas Line LOS C (S.U.E.*)	-----
U/G Gas Line LOS D (S.U.E.*)	-----
Above Ground Gas Line	-----

SANITARY SEWER:

Sanitary Sewer Manhole	⊕
Sanitary Sewer Cleanout	⊕
U/G Sanitary Sewer Line	-----
Above Ground Sanitary Sewer	-----
SS Forced Main Line LOS B (S.U.E.*)	-----
SS Forced Main Line LOS C (S.U.E.*)	-----
SS Forced Main Line LOS D (S.U.E.*)	-----

MISCELLANEOUS:

Utility Pole	●
Utility Pole with Base	□
Utility Located Object	○
Utility Traffic Signal Box	⊕
Utility Unknown U/G Line LOS B (S.U.E.*)	-----
U/G Tank; Water, Gas, Oil	□
Underground Storage Tank, Approx. Loc.	⊕
A/G Tank; Water, Gas, Oil	□
Geoenvironmental Boring	⊕
U/G Test Hole LOS A (S.U.E.*)	⊕
Abandoned According to Utility Records	AATUR
End of Information	E.O.I.

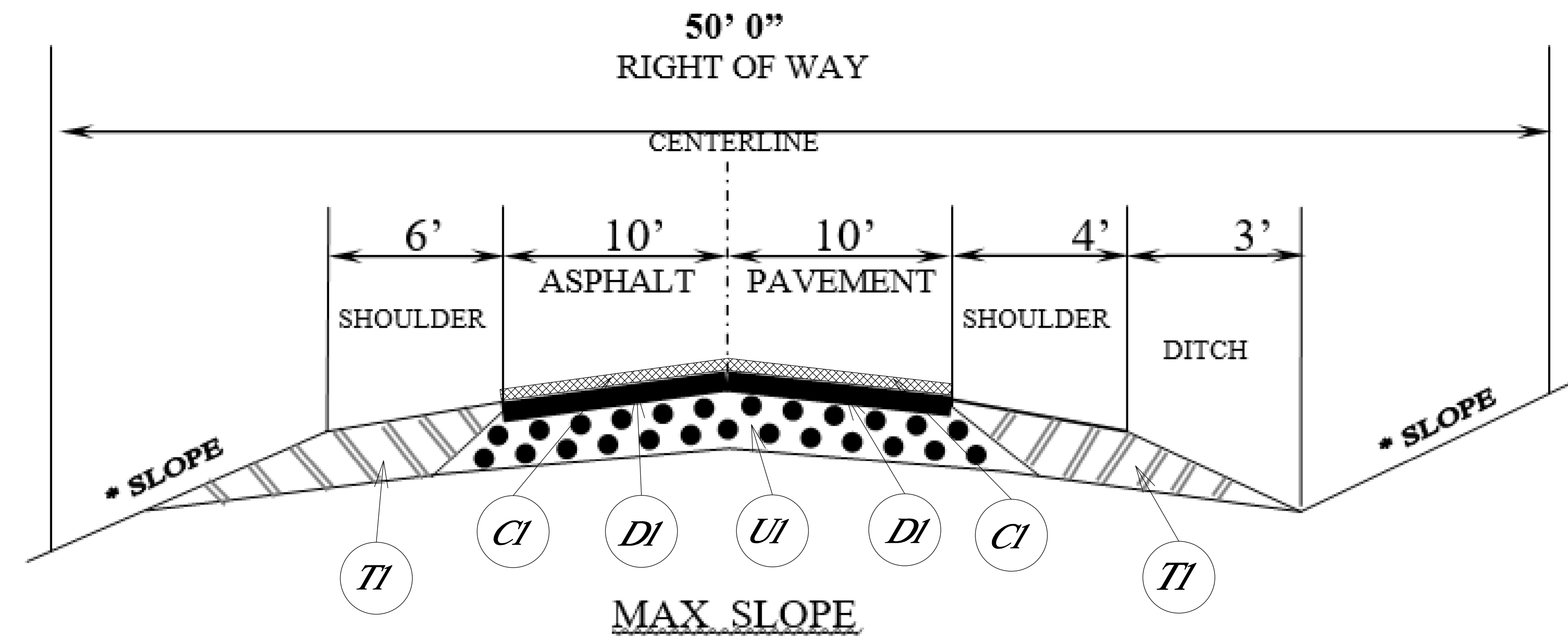

FILL 1 1/2:1

CUT 1:1

PAVEMENT SCHEDULE

C1	PROP. APPROX. 1 1/2" ASPHALT CONCRETE SURFACE COURSE, TYPE S9.5B AT AN AVERAGE RATE OF 168 LBS PER SQ YARD.
D1	PROP. APPROX. 2 1/2" ASPHALT CONCRETE INTERMEDIATE COURSE, TYPE I19.0B AT AN AVERAGE RATE OF 285 LBS PER SQ YARD.
T1	SHOULDER RECONSTRUCTION - AGGREGATE SHOULDER BORROW.
U1	EXISTING SUBGRADE (STONE BASE).

STATE	STATE PROJECT REFERENCE NO.	SHEET NO.	TOTAL SHEETS
N.C.	14C.045155	1	
TIP NO.	WBS NO.	DESCRIPTION	
	14C.045155		

STATE OF NORTH CAROLINA
DIVISION OF HIGHWAYS

HENDERSON COUNTY

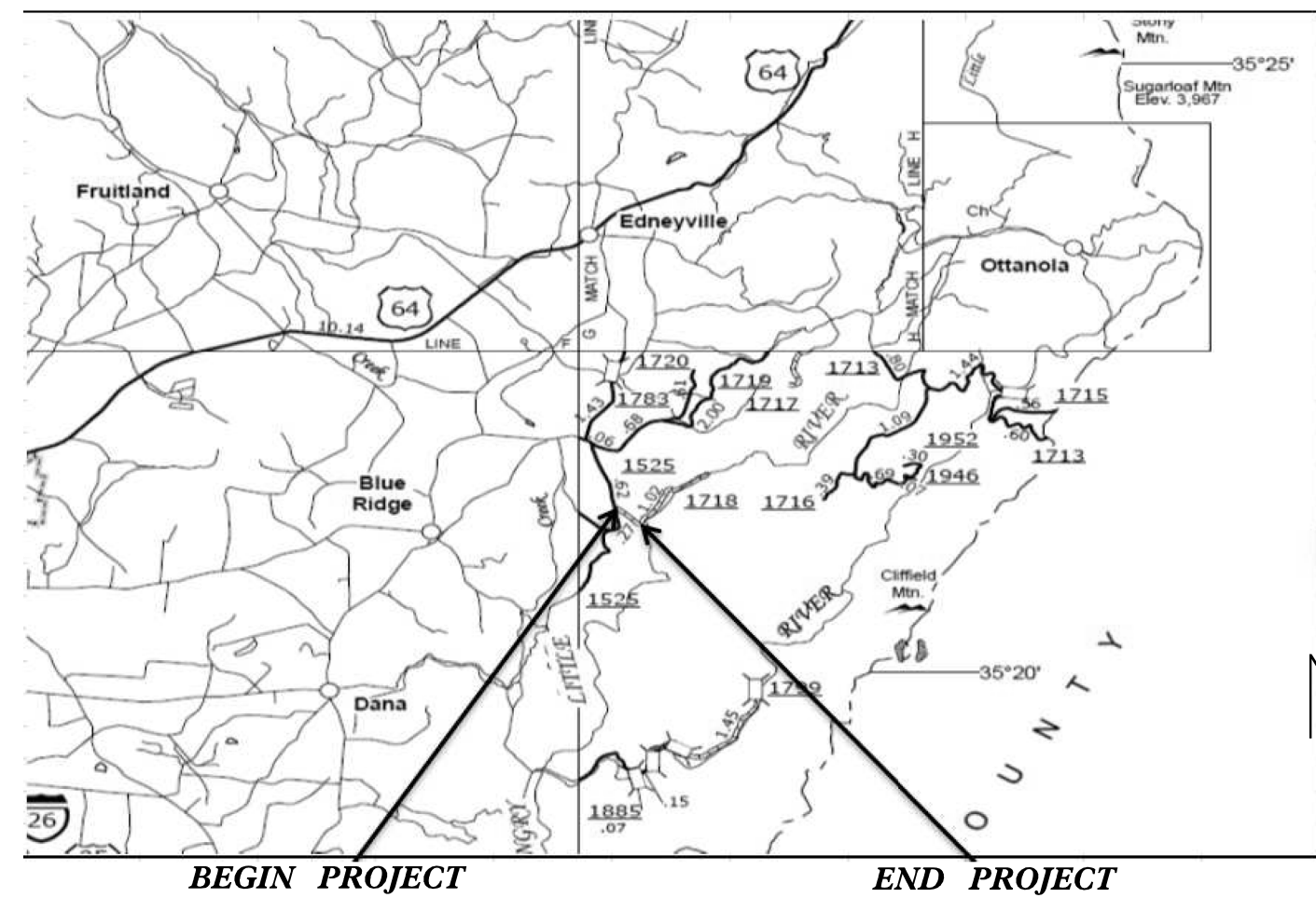

LOCATION: BEGIN AT THE INTERSECTION OF SR1525 (UNION HILL ROAD) AND SR1718A (LITTLE HUNGRY ROAD) AND CONTINUE IN A SOUTH-EASTERLY DIRECTION FOR A TOTAL OF 1,310 FEET TO END OF PROJECT.

TYPE OF WORK: PAVE, SHOULDER RECONSTRUCTION, PAVEMENT MARKING, TRAFFIC CONTROL.

TIP PROJECT: 14C.045155

CONTRACT: DN00382

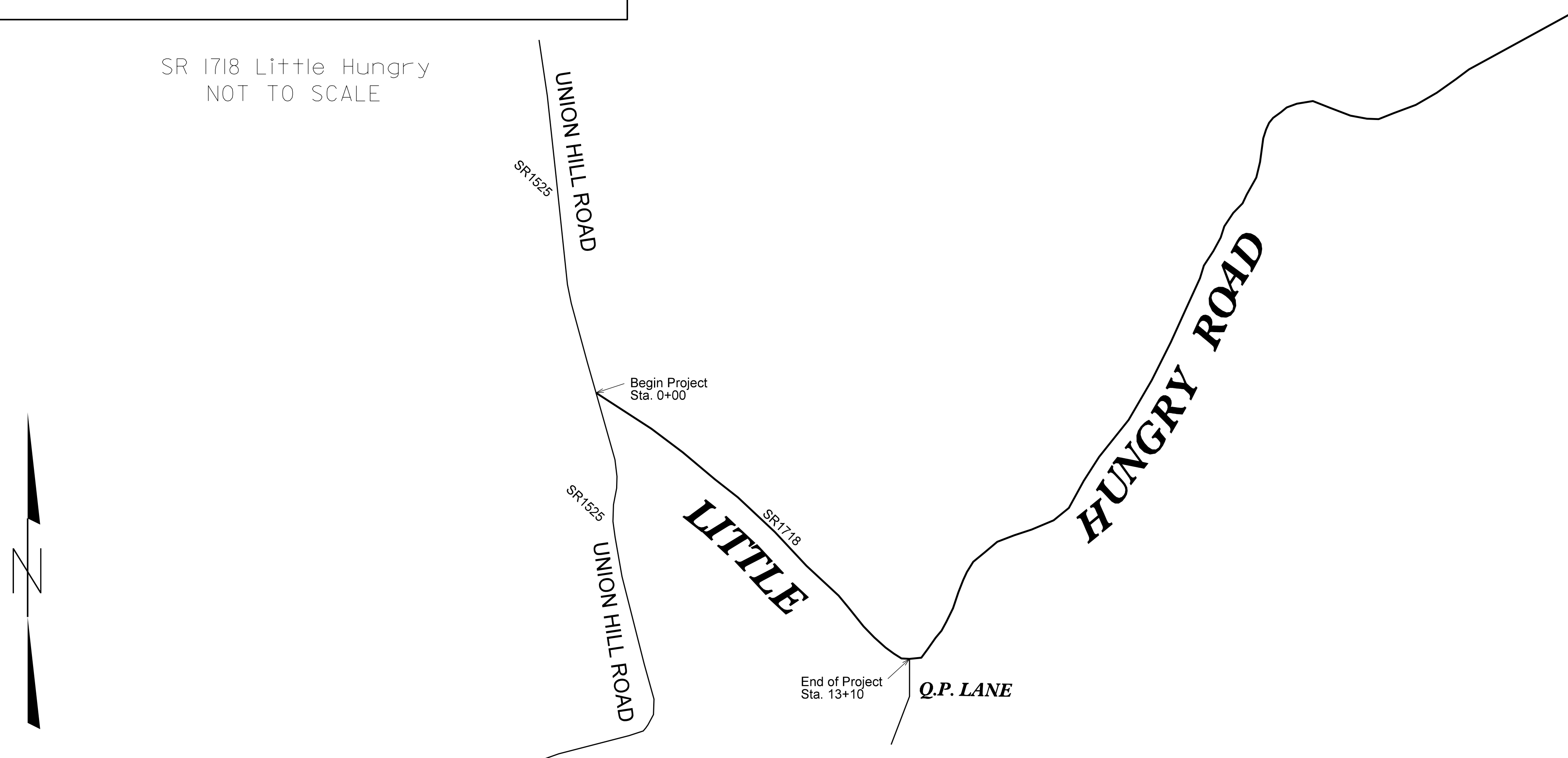

SR 1718 Little Hungry
NOT TO SCALE

NOT TO SCALE

PROJECT LENGTH

LITTLE HUNGRY ROAD - 14C.045155 (0.25 MILES)

Prepared In the Office of:
DIVISION OF HIGHWAYS
1000 Birch Ridge Dr., Raleigh NC, 27610

2012 STANDARD SPECIFICATIONS	
RIGHT OF WAY DATE:	S.L. Cannon, PE PROJECT ENGINEER
LETTING DATE:	R.C. Chambard PROJECT DESIGN ENGINEER

HYDRAULICS ENGINEER

SIGNATURE: _____ P.E.

ROADWAY DESIGN ENGINEER

SIGNATURE: _____ P.E.

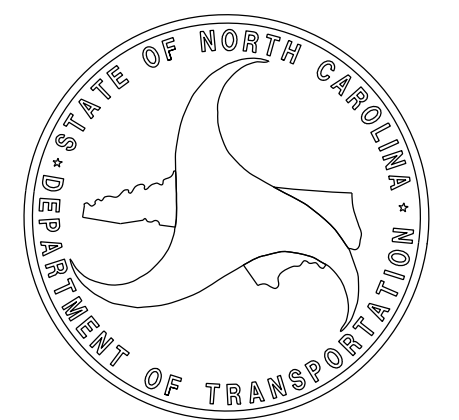

08/03/2017

GENERAL NOTES:

ALL THE STANDARD DRAWINGS LISTED IN THIS CONTRACT, MAY OR MAY NOT BE APPLICABLE.

UTILITY OWNERS ON THIS PROJECT ARE:

MORRIS BROADBAND LLC. (828-772-1167), AT&T (1-800-778-9140), PSNC ENERGY (877-776-2427), DUKE ENERGY (800-769-3766),

ANY RELOCATION OF EXISTING UTILITIES WILL BE ACCOMPLISHED BY OTHERS.

INDEX OF SHEETS

<u>SHEET NUMBER:</u>	<u>SHEET:</u>
<i>1</i>	<i>TITLE SHEET</i>
<i>1A</i>	<i>INDEX OF SHEETS</i>
<i>1B</i>	<i>CONVENTIONAL SYMBOLS</i>
<i>2A</i>	<i>PAVEMENT SCHEDULE & TYPICAL</i>

2012 STANDARD SPECIFICATIONS FOR ROADS AND STRUCTURES *EFF. 01-17-2012
REV. 10-30-2012*

The following Roadway Specifications as appear in "Standard Specifications For Roads And Structures" Highway Design Branch - N. C. Department of Transportation - Raleigh, N. C., Dated January, 2012 are applicable to this project and by reference hereby are considered a part of these plans:

- | <i>SPEC NO.</i> | <i>TITLE</i> |
|--|--|
| <i>DIVISION 5 - SUBGRADE, BASES AND SHOULDERS</i> | |
| <i>Section 535</i> | <i>Conditioning Existing Base</i> |
| <i>DIVISION 6 - ASPHALT PAVEMENTS</i> | |
| <i>Section 610</i> | <i>Asphalt Concrete Plant Mix Pavements</i> |
| <i>Section 620</i> | <i>Asphalt Binder For Plant Mix</i> |
| <i>DIVISION 11 - WORK ZONE TRAFFIC CONTROL</i> | |
| <i>Section 1105</i> | <i>Temporary Traffic Control Devices</i> |
| <i>DIVISION 12 - PAVEMENT MARKINGS, MARKERS AND DELINEATION</i> | |
| <i>Section 1205</i> | <i>Pavement Marking General Requirements</i> |

STATE OF NORTH CAROLINA, DIVISION OF HIGHWAYS
CONVENTIONAL PLAN SHEET SYMBOLS

Note: Not to Scale *S.U.E. = Subsurface Utility Engineering

BOUNDARIES AND PROPERTY:

State Line	-----
County Line	-----
Township Line	-----
City Line	-----
Reservation Line	-----
Property Line	-----
Existing Iron Pin	○
Computed Property Corner	-----
Property Monument	□
Parcel/Sequence Number	⑫
Existing Fence Line	-----
Proposed Woven Wire Fence	-----
Proposed Chain Link Fence	-----
Proposed Barbed Wire Fence	-----
Existing Wetland Boundary	-----
Proposed Wetland Boundary	-----
Existing Endangered Animal Boundary	-----
Existing Endangered Plant Boundary	-----
Existing Historic Property Boundary	-----
Known Contamination Area: Soil	-----
Potential Contamination Area: Soil	-----
Known Contamination Area: Water	-----
Potential Contamination Area: Water	-----
Contaminated Site: Known or Potential	-----

BUILDINGS AND OTHER CULTURE:

Gas Pump Vent or U/G Tank Cap	○
Sign	○
Well	○
Small Mine	⊗
Foundation	□
Area Outline	□
Cemetery	⊕
Building	□
School	□
Church	□
Dam	⊕

HYDROLOGY:

Stream or Body of Water	-----
Hydro, Pool or Reservoir	-----
Jurisdictional Stream	-----
Buffer Zone 1	-----
Buffer Zone 2	-----
Flow Arrow	-----
Disappearing Stream	-----
Spring	○
Wetland	-----
Proposed Lateral, Tail, Head Ditch	-----
False Sump	-----

RAILROADS:

Standard Gauge	-----
RR Signal Milepost	-----
Switch	-----
RR Abandoned	-----
RR Dismantled	-----

RIGHT OF WAY & PROJECT CONTROL:

Secondary Horiz and Vert Control Point	◆
Primary Horiz Control Point	○
Primary Horiz and Vert Control Point	●
Exist Permanent Easment Pin and Cap	◇
New Permanent Easment Pin and Cap	◆
Vertical Benchmark	⊠
Existing Right of Way Marker	△
Existing Right of Way Line	-----
New Right of Way Line	-----
New Right of Way Line with Pin and Cap	-----
New Right of Way Line with Concrete or Granite RW Marker	-----
New Control of Access Line with Concrete CA Marker	-----
Existing Control of Access	-----
New Control of Access	-----
Existing Easement Line	-----
New Temporary Construction Easement	-----
New Temporary Drainage Easement	-----
New Permanent Drainage Easement	-----
New Permanent Drainage / Utility Easement	-----
New Permanent Utility Easement	-----
New Temporary Utility Easement	-----
New Aerial Utility Easement	-----

ROADS AND RELATED FEATURES:

Existing Edge of Pavement	-----
Existing Curb	-----
Proposed Slope Stakes Cut	-----
Proposed Slope Stakes Fill	-----
Proposed Curb Ramp	-----
Existing Metal Guardrail	-----
Proposed Guardrail	-----
Existing Cable Guiderail	-----
Proposed Cable Guiderail	-----
Equality Symbol	⊕
Pavement Removal	-----

VEGETATION:

Single Tree	○
Single Shrub	⊗

Hedge	-----
Woods Line	-----
Orchard	-----
Vineyard	-----

EXISTING STRUCTURES:

MAJOR:	
Bridge, Tunnel or Box Culvert	-----
Bridge Wing Wall, Head Wall and End Wall	-----
MINOR:	
Head and End Wall	-----
Pipe Culvert	-----
Footbridge	-----
Drainage Box: Catch Basin, DI or JB	-----
Paved Ditch Gutter	-----
Storm Sewer Manhole	-----
Storm Sewer	-----

UTILITIES:

POWER:	
Existing Power Pole	●
Proposed Power Pole	○
Existing Joint Use Pole	●
Proposed Joint Use Pole	○
Power Manhole	⊕
Power Line Tower	⊠
Power Transformer	⊠
U/G Power Cable Hand Hole	-----
H-Frame Pole	-----
U/G Power Line LOS B (S.U.E.*)	-----
U/G Power Line LOS C (S.U.E.*)	-----
U/G Power Line LOS D (S.U.E.*)	-----

TELEPHONE:

Existing Telephone Pole	●
Proposed Telephone Pole	○
Telephone Manhole	⊕
Telephone Pedestal	⊠
Telephone Cell Tower	⊠
U/G Telephone Cable Hand Hole	-----
U/G Telephone Cable LOS B (S.U.E.*)	-----
U/G Telephone Cable LOS C (S.U.E.*)	-----
U/G Telephone Cable LOS D (S.U.E.*)	-----
U/G Telephone Conduit LOS B (S.U.E.*)	-----
U/G Telephone Conduit LOS C (S.U.E.*)	-----
U/G Telephone Conduit LOS D (S.U.E.*)	-----
U/G Fiber Optics Cable LOS B (S.U.E.*)	-----
U/G Fiber Optics Cable LOS C (S.U.E.*)	-----
U/G Fiber Optics Cable LOS D (S.U.E.*)	-----

WATER:

Water Manhole	⊕
Water Meter	○
Water Valve	⊗
Water Hydrant	⊕
U/G Water Line LOS B (S.U.E.*)	-----
U/G Water Line LOS C (S.U.E.*)	-----
U/G Water Line LOS D (S.U.E.*)	-----
Above Ground Water Line	-----

TV:

TV Pedestal	⊠
TV Tower	⊗
U/G TV Cable Hand Hole	-----
U/G TV Cable LOS B (S.U.E.*)	-----
U/G TV Cable LOS C (S.U.E.*)	-----
U/G TV Cable LOS D (S.U.E.*)	-----
U/G Fiber Optic Cable LOS B (S.U.E.*)	-----
U/G Fiber Optic Cable LOS C (S.U.E.*)	-----
U/G Fiber Optic Cable LOS D (S.U.E.*)	-----

GAS:

Gas Valve	◇
Gas Meter	⊕
U/G Gas Line LOS B (S.U.E.*)	-----
U/G Gas Line LOS C (S.U.E.*)	-----
U/G Gas Line LOS D (S.U.E.*)	-----
Above Ground Gas Line	-----

SANITARY SEWER:

Sanitary Sewer Manhole	⊕
Sanitary Sewer Cleanout	⊕
U/G Sanitary Sewer Line	-----
Above Ground Sanitary Sewer	-----
SS Forced Main Line LOS B (S.U.E.*)	-----
SS Forced Main Line LOS C (S.U.E.*)	-----
SS Forced Main Line LOS D (S.U.E.*)	-----

MISCELLANEOUS:

Utility Pole	●
Utility Pole with Base	□
Utility Located Object	○
Utility Traffic Signal Box	⊠
Utility Unknown U/G Line LOS B (S.U.E.*)	-----
U/G Tank; Water, Gas, Oil	-----
Underground Storage Tank, Approx. Loc.	-----
A/G Tank; Water, Gas, Oil	-----
Geoenvironmental Boring	⊕
U/G Test Hole LOS A (S.U.E.*)	-----
Abandoned According to Utility Records	AATUR
End of Information	E.O.I.

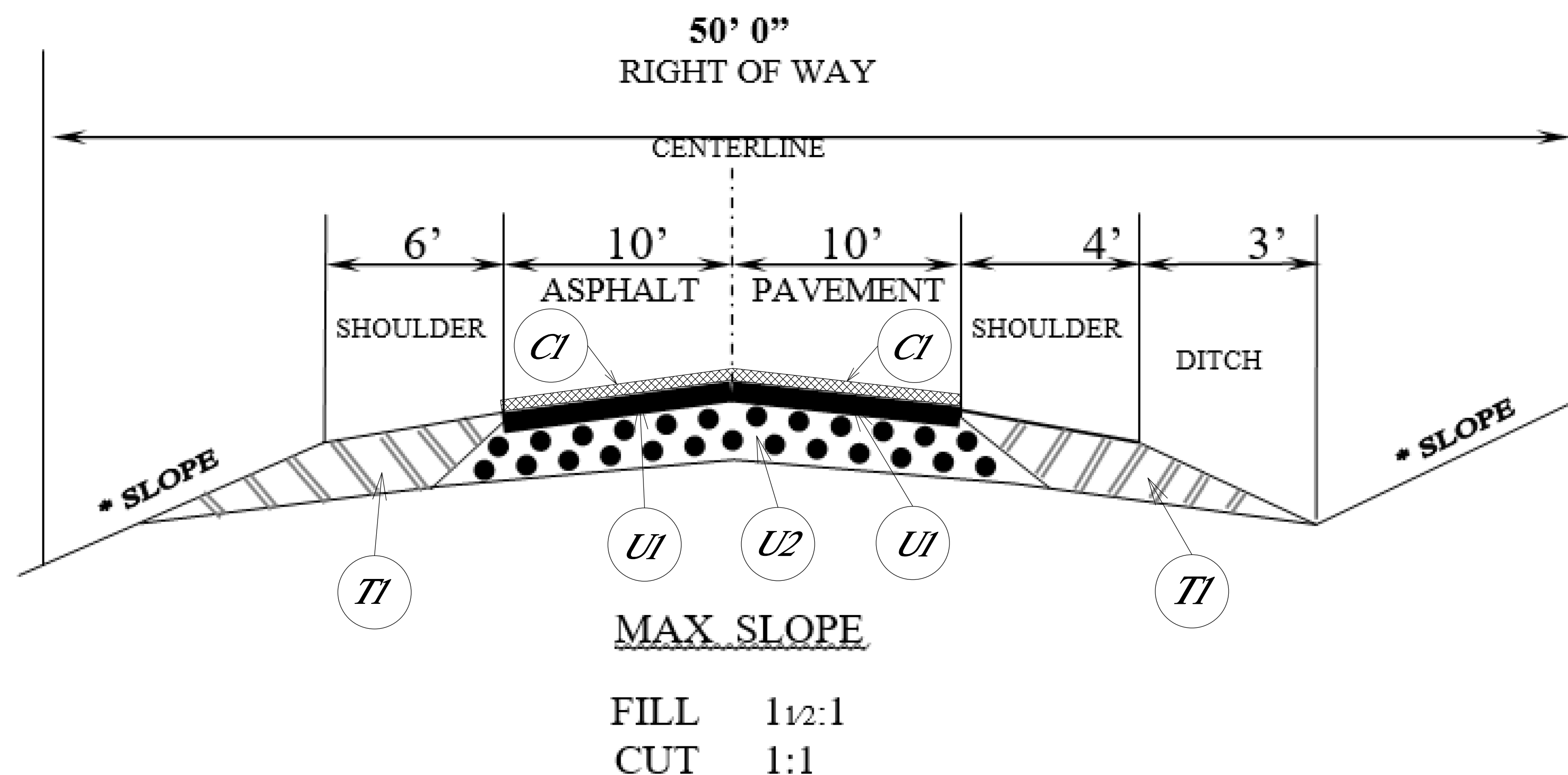

PAVEMENT SCHEDULE

C1	PROP. APPROX. 1 1/2" ASPHALT CONCRETE SURFACE COURSE. TYPE S9.5B AT AN AVERAGE RATE OF 168 LBS PER SQ YARD.
T1	SHOULDER RECONSTRUCTION - EARTH MATERIAL.
U1	EXISTING PAVEMENT (ASPHALT SURFACE TREATMENT).
U2	EXISTING SUBGRADE (STONE BASE).